

FINDS

HOT TIPS &
BEST BUYS

FEAR AND LOATHING AT HOME

Worried about fire? No problem, with a handy-dandy escape ladder (\$30 for a two-story getaway and \$42 for three stories). Electrocutation? Easily prevented with a ground-fault circuit-interrupter duplex outlet (\$15), which can be used in kitchens, bathrooms or anywhere electricity and water mix.

SAVE (AT) THE WHALE!

Just because you don't have a "resale number" and don't want to hire an architect or professional interior designer doesn't mean you can't shop the chichi furniture showrooms, presumably

open only "to the trade" at the Pacific Design Center. For a mere \$10 an hour, a trained professional at L.A. Design Concepts (8811 Alden Dr., Suite 11A, 213-276-2109) will escort you through any of the showrooms you want to

visit in the famed Blue Whale. If you see something you want to buy, this no-frills service handles all purchasing, expediting, delivery and follow-up for 15 percent over wholesale. And there is no minimum fee.

—Kathryn Spence

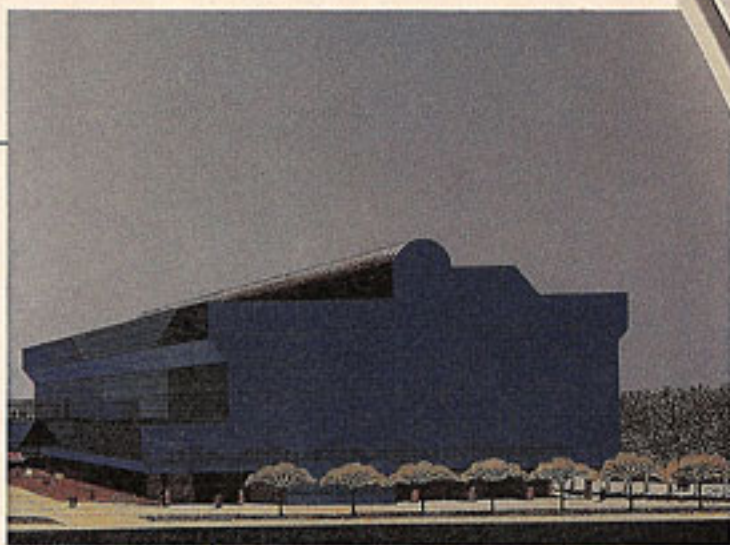

PRIVATE SCHOOL & CAMP GUIDE • AUSTRALIA, FOR EXPO • POP COLLECTIBLES

Los Angeles
APRIL 1988 • \$2.50

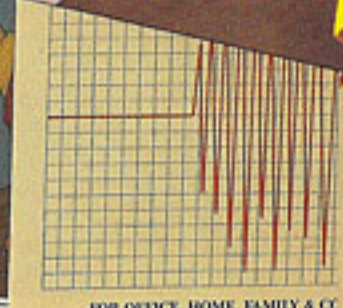

FOR OFFICE, HOME, FAMILY & CC
Libby Laffero